

N:\JOBS\0313 FAB Part II\Ford Assembly Building dwgs\October 2003 - From CD\1-CENTR CORRIDOR DWGS\Craneway Example\Craneway Table Layout Plans\FAB Craneway Table Layout Plan - SEAT2 - June 2008 Stage East.dwg, 7/18/2008 2:16:57 PM

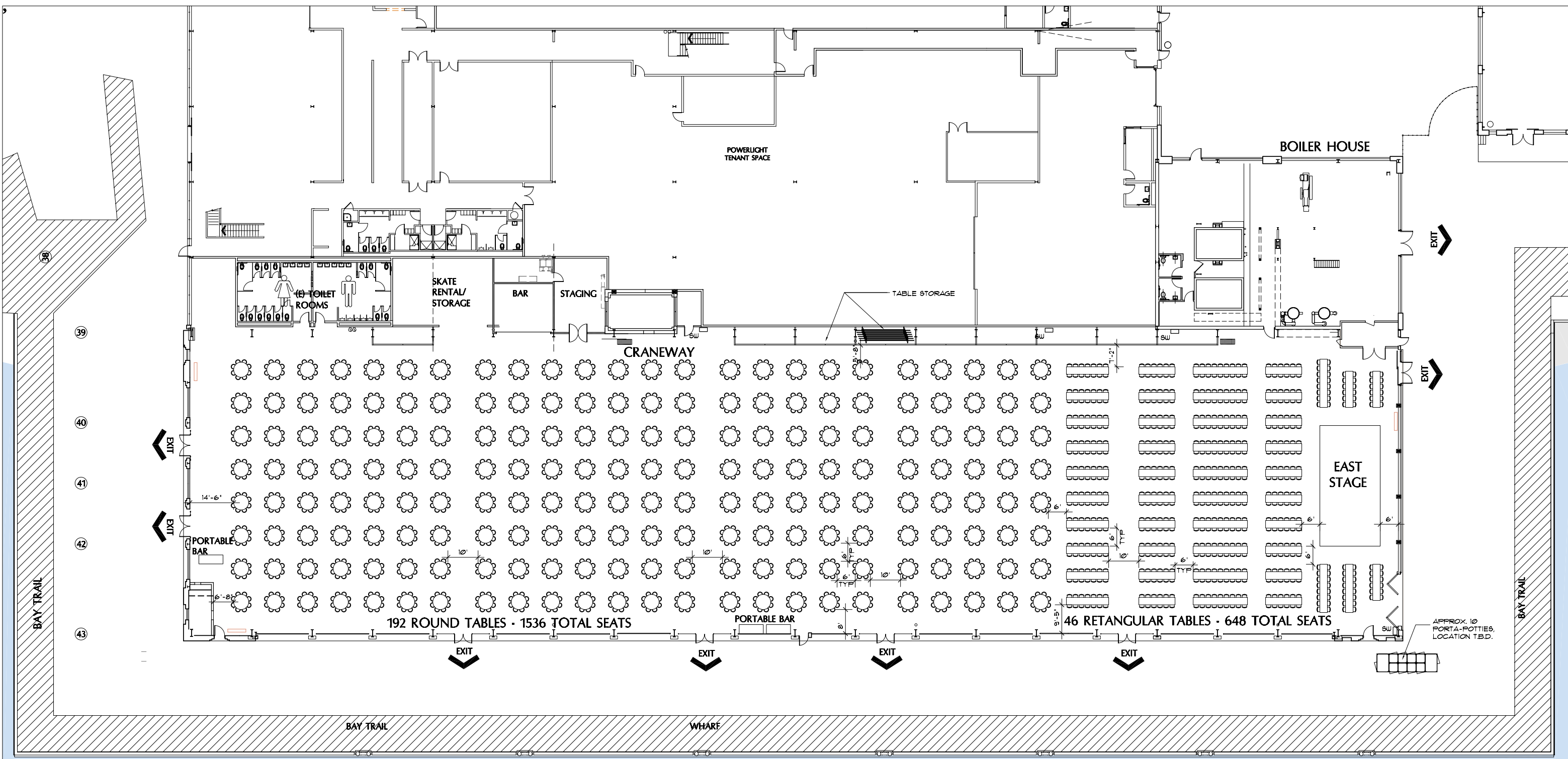

192 ROUND TABLES - 1536 TOTAL SEATS

46 RETANGULAR TABLES - 648 TOTAL SEATS

APPROX. 10 PORTA-POTTIES. LOCATION T.B.D.

FUTURE FERRY DOCK BY OTHERS

W V U T S R Q P N M L K J H G F E D C B A

SAN FRANCISCO BAY

1 PARTIAL FIRST FLOOR PLAN -CRANEWAY



2184 TOTAL SEATS

"approximate table and stage location for 2184 person capacity aisle spacing shown will be maintained at all times."

FORD ASSEMBLY BUILDING

1414 HARBOUR WAY SOUTH
RICHMOND, CALIFORNIA 94804

Developer:
Orton
Development, Inc.
3049 Research Dr.
Richmond, CA 94806
tel: (510) 428-0800

Architect:
MARCY WONG
& DONN LOGAN
ARCHITECTS
816 Bancroft Way
Berkeley, CA 94710
tel: (510) 843-0916

Consultant:

Stamp:

Revisions:

Sheet Name:
**SEATING PLAN
CRANEWAY WITH EAST STAGE**

Phase:
Date: 18 JULY, 2008
By: KR, KS, JT

Sheet Number:

SEAT-2